

**REGOLAZIONE
ADJUSTMENT**

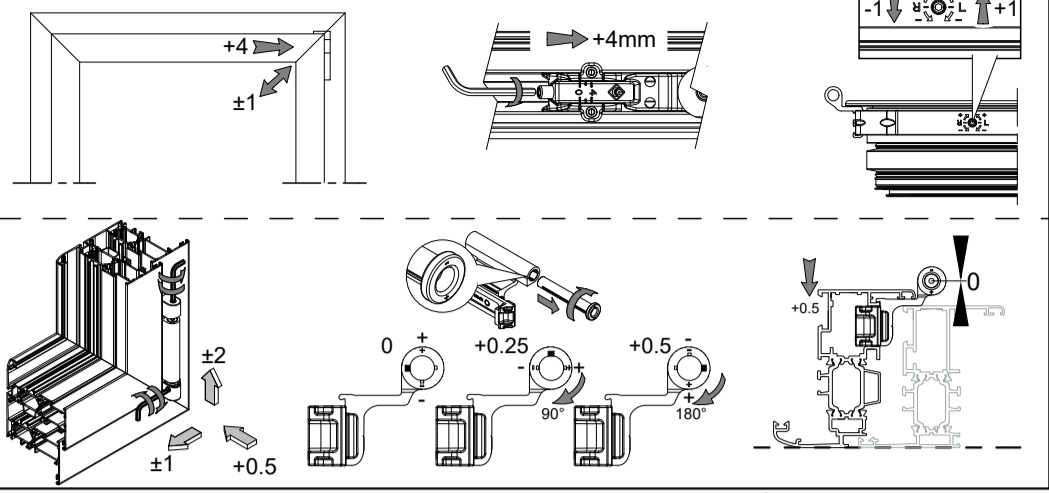

3400.24		3400F.1 / 3400F.151 3400F.401											3420.24		3420F.1 / 3420F.150 3420F.151 3420F.158 / 3420F.401													
100 Kg		3400LF.1											160 Kg		3420LF.1													
2700	40	37	30	25	21	19	16	15	13	12	11	11	2700	50	50	47	40	34	30	26	24	22	20	18	17	16	15	14
2600	42	38	31	26	22	19	17	15	14	13	12	11	2600	50	50	49	41	35	31	27	25	22	21	19	18	16	15	14
2500	43	40	32	27	23	20	18	16	15	13	12	11	2500	50	50	50	43	37	32	28	26	23	21	20	18	17	16	15
2400	45	42	33	28	24	21	19	17	15	14	13	12	2400	50	50	50	44	38	33	30	27	24	22	21	19	18	17	16
2300	47	43	35	29	25	22	19	17	16	14	13	12	2300	50	50	50	46	40	35	31	28	25	23	21	20	19	17	16
2200	49	45	36	30	26	23	20	18	17	15	14	13	2200	50	50	50	48	42	36	32	29	26	24	22	21	19	18	17
2100	50	48	38	32	27	24	21	19	17	16	15	14	2100	50	50	50	50	44	38	34	30	28	25	23	22	20	19	16
2000	50	50	40	33	29	25	22	20	18	17	15	14	2000	50	50	50	50	46	40	36	32	29	27	25	23	21	20	17
1900	50	50	42	35	30	26	23	21	19	18	16	15	1900	50	50	50	50	48	42	37	34	31	28	26	24	22	19	18
1800	50	50	44	37	32	28	25	22	20	19	17	16	1800	50	50	50	50	44	40	36	32	30	27	25	21	20	19	
1700	50	50	47	39	34	29	26	24	21	20	18	15	1700	50	50	50	50	47	42	38	34	31	29	24	23	21	20	
1600	50	50	50	42	36	31	28	25	23	21	17	16	1600	50	50	50	50	50	44	40	36	33	28	26	24	23	18	
1500	50	50	50	44	38	33	30	27	24	22	18	17	1500	50	50	50	50	50	47	43	39	36	30	27	26	20	15	
1400	50	50	50	48	42	37	30	27	25	19	14	13	1400	50	50	50	50	50	46	42	34	32	29	23	17	16		
1300	50	50	50	50	44	38	34	31	25	23	21	16	1300	50	50	50	50	50	49	40	37	34	26	20	18	12		
1200	50	50	50	50	48	42	37	30	27	25	19	14	1200	50	50	50	50	50	50	48	44	40	31	23	21	13	6	
1100	50	50	50	50	50	45	36	33	30	23	17	16	1100	50	50	50	50	50	50	48	36	27	25	16	7	X	X	
1000	50	50	50	50	50	50	40	36	27	20	18	11	1000	50	50	50	50	50	50	44	32	30	18	9	X	X	X	
900	50	50	50	50	50	50	44	27	24	15	7	X	900	50	50	50	50	50	50	43	39	24	11	X	X	X	X	
800	50	50	50	50	50	50	33	30	18	8	X	X	800	50	50	50	50	50	50	48	29	13	X	X	X	X	X	
700	50	50	50	50	50	50	43	38	11	X	X	X	700	50	50	50	50	50	50	18	X	X	X	X	X	X	X	
600	50	50	50	50	50	50	33	15	X	X	X	X	600	50	50	50	50	50	50	24	X	X	X	X	X	X	X	
500	50	50	50	50	50	50	46	X	X	X	X	X	500	50	50	50	50	X	X	X	X	X	X	X	X	X	X	

Con 3400L.22 H anta min.700 mm
With 3400L.22 H sash min. 700 mm

20	IT	Anta eseguibile con spessore vetro Max 20 mm	X	IT	Dimensione non eseguibile
	EN	Sash size executable with Max glass thickness 20 mm		EN	Not feasible

Norma di riferimento Europea UNI EN 13126-1:2006 / 13126-8:2006 | Certified according to European Standard UNI EN 13126-1:2006 / 13126-8:2006

1550x1400	4	160	0	1	4	-	8	-
Dimensione di prova	Durabilità	Massa	Resistenza fuoco	Sicurezza di utilizzo	Resistenza alla corrosione	Resistenza effrazione	Applicazione	Categoria d'uso
Test size	Durability	Mass	Fire resistance	Safety in use	Corrosion resistance	Security	Applicable part	Category of use

Kit anta ribalta versione F con AFM su cremonese | Per sistemi Camera Europea
Kit for tilt and turn version F with AFM on the cremone bolt | For Euro Groove system

3400F.1 / 3420F.1 / 3420F.158
3400F.401 / 3420F.401
3420F.150 / 3400F.151 / 3420F.151
3400LF.1 / 3420LF.1

Riferimento nodo Camera Europea
Euro groove section referimnt

B	C	D	E
14	4	18	1.5
13.5	3.2	16.8	2.4
12	2.9	15	1.5
10	4.2	14.5	1.5

LAVORAZIONI / MACHINING

NOTE: nel caso di utilizzo cremonese con interasse 90mm utilizzare Part. 6015.3 | NOTE: in case of cremone-bolt with inter-axe 90mm use art. 6015.3

LAVORAZIONI ASTINE
RODS MACHINING

Maniglie
Handles

6018	6038 6038.20D/S	6015 - 6015.3 6011 - 6011.10	6036 - 6032.10 - 6036.3 6036.20D/S 6036.23D/S	6061	6063 6063.20
3072	3077.2 3077.25D/S	3070	3070.2 3075.25D/S	3100	3101 3101.25

MASTER S.r.l. - I616F - A3 FR- 25/01/2023 | La master si non è risponde in alcun modo di possibili inesattezze imputabili ad errori di stampa o di trascrizione del presente foglio | Master does not bear any responsibility for possible inaccuracies due to printing mistakes or to transcription

Posizionamento punti chiusura kit base | Base kit locking points positioning

ANTA RIBALTA | TILT AND TURN

AFM •

Ribalta Tilt
Apertura Open
Chiusura Locking

3400F.1 / 3420F.1 / 3420F.158 / 3400F.401
3420F.401 / 3420F.150 / 3400F.151 / 3420F.151

*non presente nei kit | not included in kits
3400F.1 - 3400F.151- 3400F.401

MANOVRA LOGICA | TILT BEFORE TURN

AFM •

Apertura Open
Ribalta Tilt
Chiusura Locking

3400LF.1 / 3420LF.1

*non presente nei kit | not included in kit
3400LF.1

3420.24

⚠ **OBLIGATORIO PER PESI > 100kg**
 ⚠ **MANDATORY FOR WEIGHT > 100kg**
 ⚠ **OBLIGATOIRE POUR LES POIDS > 100 kg**
 ⚠ **OBLIGATORIO DE PESO > 100kg**

160kg

14.9

3.3

3400.50

Ø3.5

Utensili utilizzati ALLEN n°3
 Tools used
 Coppia / Torque MAX 3.5Nm

3400.24

100kg

Utensili utilizzati ALLEN n°3
 Tools used
 Coppia / Torque MAX 3.5Nm

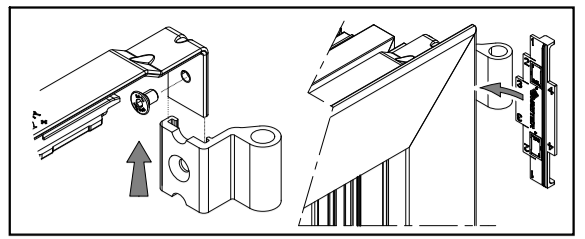

*** Perno microventilazione integrata**
Da abbinare a 3400.39
Built-in microventilation pin
In combination with 3400.39

⚠

PER L>500 E APERTURA IMPEDITA A 180°
 BRACCIO LIMITATORE CONSIGLIATO
 IT IS RECOMMENDED TO USE A LIMITER ARM
 FOR WINDOWS WIDTH >500 AND FOR WINDOWS WITH 180° RESTRICTED OPENING

10"

NO 180°

1203A.10
 >390mm <1701mm

Telaio - Frame

Anta - Sash

255

MANOVRA LOGICA - TBT
3550L.30 + 3400L.22

L - 692

ANTA RIBALTA - T&T
3550.30 + 3400.22

1200 mm < L . 1700 mm

L-965

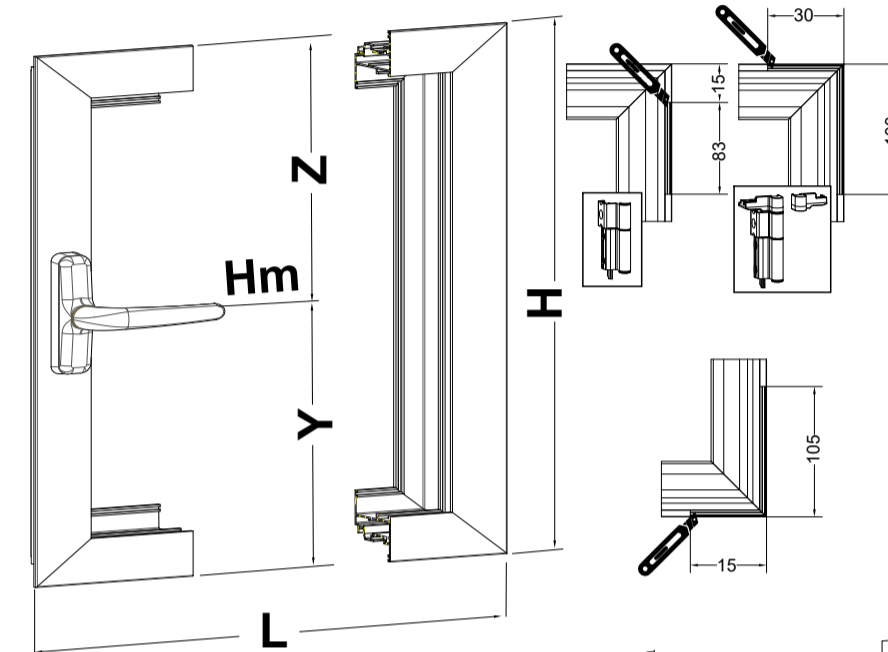

* 651 mm < L . 1200 mm

L - 543

3400.22 3400L.22

* 451 mm < L . 650 mm

L - 356

3400.21 3400L.21

370 mm < L . 450 mm

L - 340

3400.20 3400L.20

3400F.1 / 3420F.1 / 3420F.158 / 3400F.401 / 3420F.401 / 3400F.150 / 3420F.151 / 3400L.F.1 / 3420L.F.1

Z - 166

Y - 132

Z - 246

3400F.32

3627 / 3627.2

Y - 163

Z-249

3400F.32

3630 / 3630.20

Y - 166

3400.24

3420.24

LOGICA DOPPIA ANTA TBT
DOUBLE SASH

(a)	Y - 140
(b)	Y - 171
(c)	Y - 174

H/2 - 166

H > 1400 mm

3420F.31

L/2 - 132

L > 1200 mm

3400.35

3420F.31

H/2 - 400

H > 2200 mm

3400F.32

**REGOLAZIONE
ADJUSTMENT**

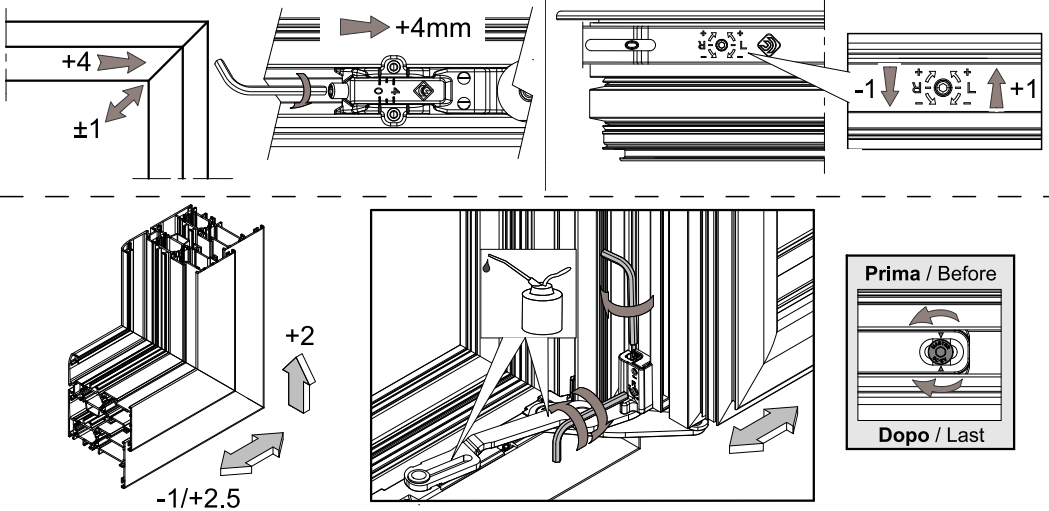

130Kg - 180° **A3310.50**

Obbligatorio A3310.50 con soglie ribassate
Mandatory A3310.50 with low threshold

Consigliato A3310.50 per portate >110Kg
Recommended A3310.50 with weights >110Kg

2500	50	42	35	30	26	23	21	19	17	16	15	14	
2400	50	43	36	31	27	24	22	20	18	17	15	14	
2300	50	45	38	32	28	25	23	21	19	17	15	15	
2200	50	47	39	34	30	26	24	21	20	18	16	16	
2100	50	50	41	35	31	28	25	23	21	19	17	17	
2000	50	50	43	37	33	29	26	24	22	20	18	17	
1900	50	50	46	39	34	30	27	25	23	21	19	18	
1800	50	50	48	41	36	32	29	26	24	22	20	17	
1700	50	50	50	44	38	34	31	28	25	24	20	18	
1600	50	50	50	46	41	36	33	30	27	23	21	20	
1500	50	50	50	50	43	39	35	32	29	24	21	21	
1400	50	50	50	50	46	41	37	34	28	26	22	19	
1300	50	50	50	50	50	44	40	33	30	28	24	17	
1200	50	50	50	50	48	39	35	33	25	21	17	17	
1100	50	50	50	50	50	47	43	39	30	22	19	13	
1000	50	50	50	50	50	47	35	26	24	15	7		
900	50	50	50	50	50	35	32	19	9	X	X	X	
800	50	50	50	50	50	30	24	11	X	X	X	X	
700	50	50	50	50	50	15	X	X	X	X	X	X	
600	50	50	50	50	43	19	X	X	X	X	X	X	
550	50	50	50	50	X	X	X	X	X	X	X	X	
H	L	470	500	600	700	800	900	1000	1100	1200	1300	1400	1500

150Kg - 90° **A3310.50**

Obbligatorio A3310.50
Mandatory A3310.50

2700	50	44	37	32	28	25	22	20	19	17	16	15	14	13
2600	50	46	38	33	29	26	23	21	19	18	16	15	14	14
2500	50	48	40	34	30	27	24	22	20	18	17	16	15	14
2400	50	50	42	36	31	28	25	23	21	19	18	17	16	15
2300	50	50	43	37	33	29	26	24	22	20	19	17	16	15
2200	50	50	45	39	34	30	27	25	23	21	19	18	17	16
2100	50	50	48	41	36	32	29	26	24	22	20	19	18	15
2000	50	50	50	43	38	33	30	27	25	23	21	20	19	16
1900	50	50	50	45	39	35	32	29	26	24	23	21	18	17
1800	50	50	50	48	42	37	33	30	28	26	24	20	19	18
1700	50	50	50	50	44	39	35	32	29	27	23	21	20	19
1600	50	50	50	50	47	42	38	34	31	26	24	23	21	17
1500	50	50	50	50	50	44	40	36	33	28	26	24	19	14
1400	50	50	50	50	50	48	43	39	32	30	28	21	16	15
1300	50	50	50	50	50	50	46	38	35	32	25	18	17	11
1200	50	50	50	50	50	50	45	41	38	23	21	20	13	6
1100	50	50	50	50	50	50	49	45	27	25	23	15	6	X
1000	50	50	50	50	50	50	33	30	28	17	7	X	X	X
900	50	50	50	50	50	50	40	36	22	10	X	X	X	X
800	50	50	50	50	50	50	45	27	11	X	X	X	X	X
700	50	50	50	50	50	50	17	X	X	X	X	X	X	X
600	50	50	50	50	50	19	X	X	X	X	X	X	X	X
550	50	50	50	50	50	X	X	X	X	X	X	X	X	X
H	L	470	500	600	700	800	900	1000	1100	1200	1300	1400	1500	1700

Es. **IT** Anta eseguibile con spessore vetro Max 20 mm
20 **EN** Sash size executable with Max glass thickness 20 mm

X Dimensione non eseguibile
 EN Not feasible

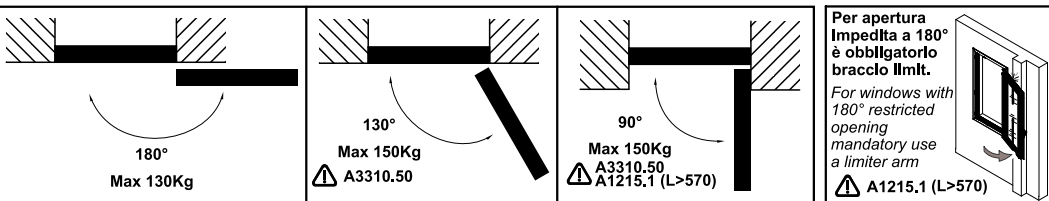

Kit anta ribalta a scomparsa | Per sistemi Camera Europea
Hidden kit for tilt and turn | For Euro Groove system

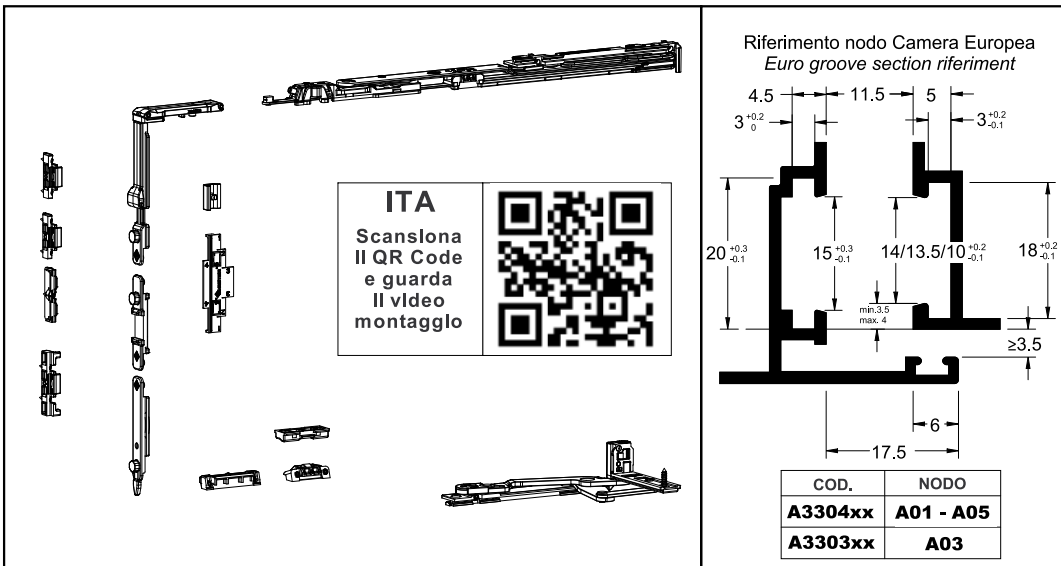

LAVORAZIONI / MACHINING

NOTA: nel caso di utilizzo cremoneese con interasse 98mm utilizzare Part. 6015.3
NOTE: in case of cremone-bolt with inter-axe 98mm use art. 6015.3

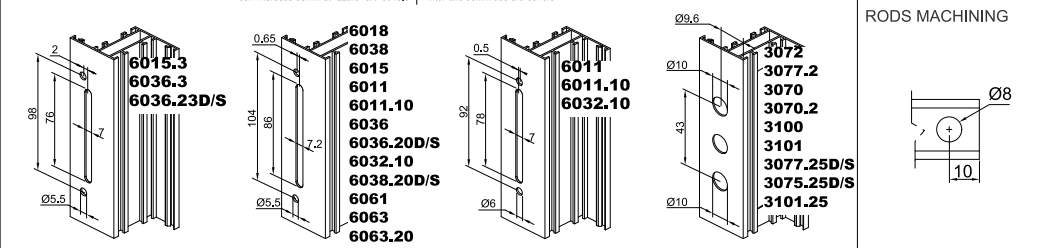

Maniglie
Handles

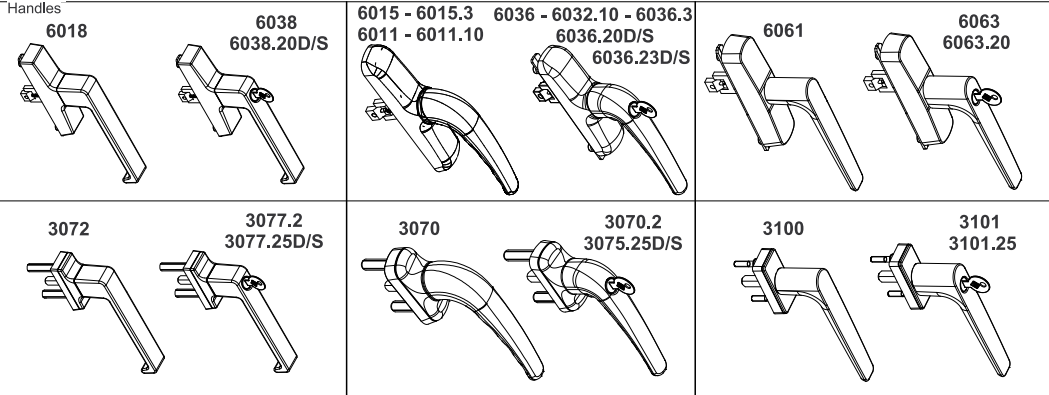

MASTER S.r.l. - I611D - A3 FR - 15/11/2022 La Master srl non è responsabile in alcun modo di possibili inesattezze tipografiche ed errori di stampa o di trascrizione dal presente foglio. Master does not bear any responsibility for possible inaccuracies due to printing mistakes or to transcription.

Posizionamento punti chiusura | Positioning locking points | Positionnement points de fermeture | Posicionamiento puntos de cierre

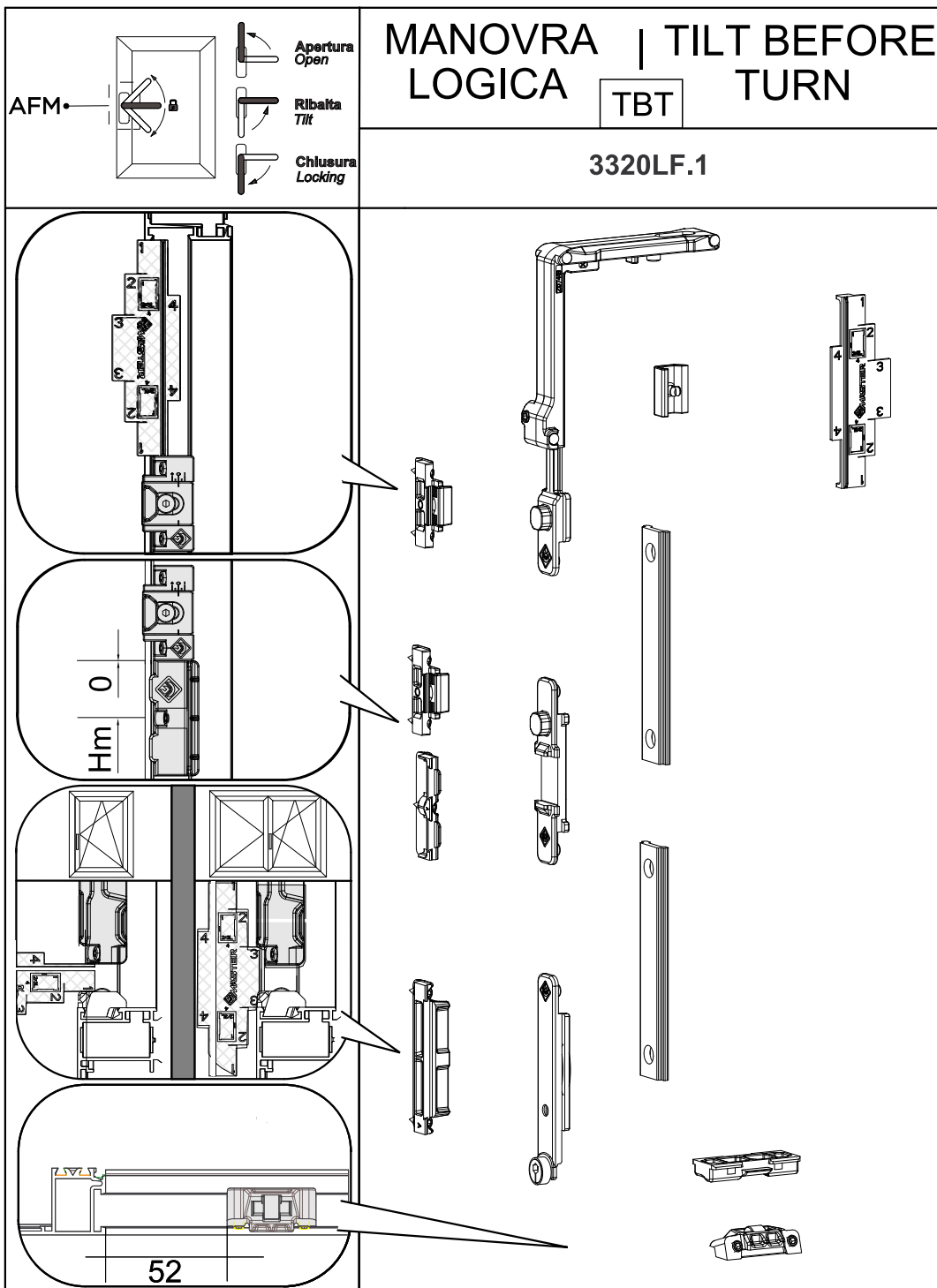
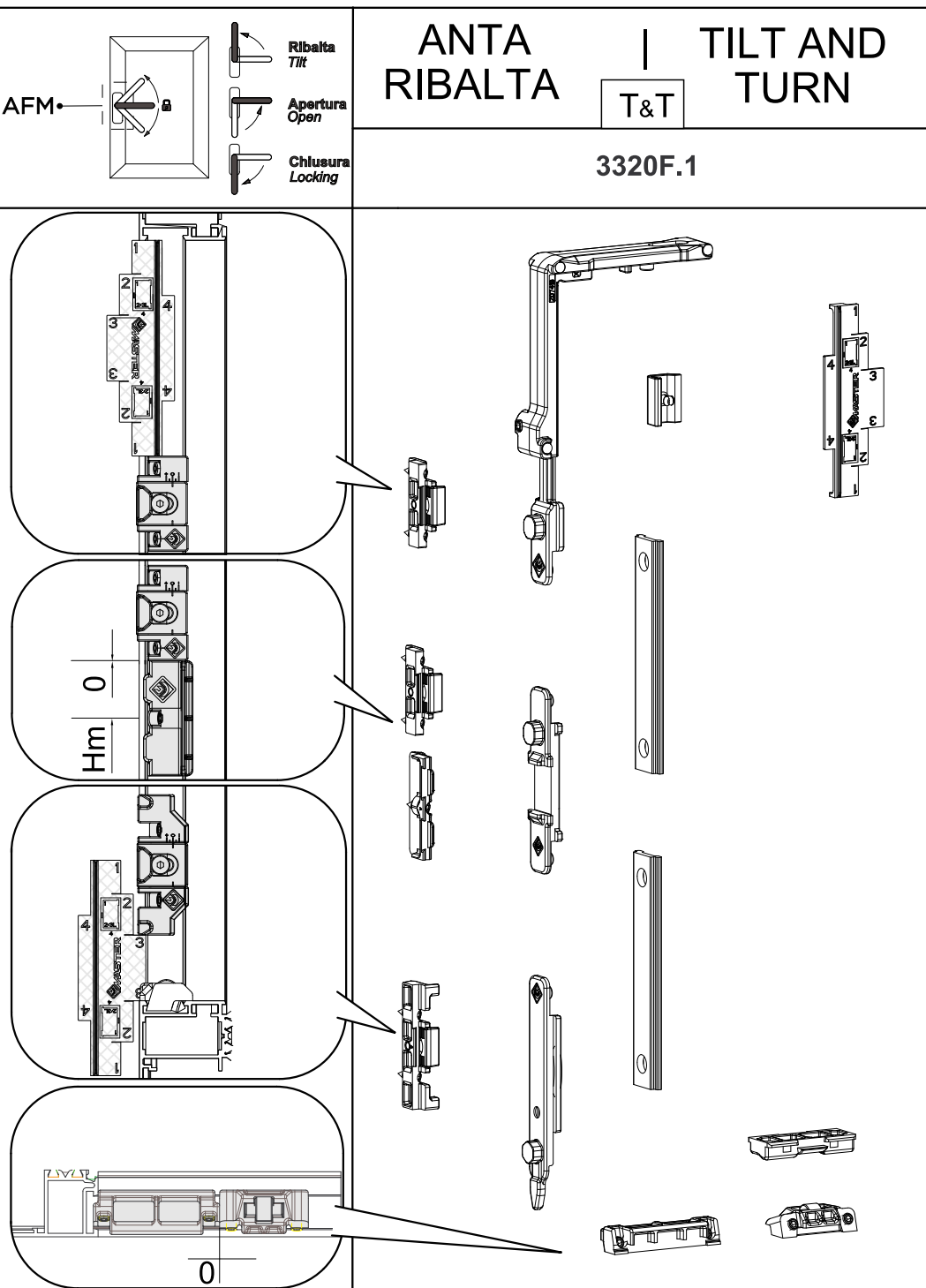

MONTAGGIO CERNIERE TELAIO
HINGE FRAME ASSEMBLY

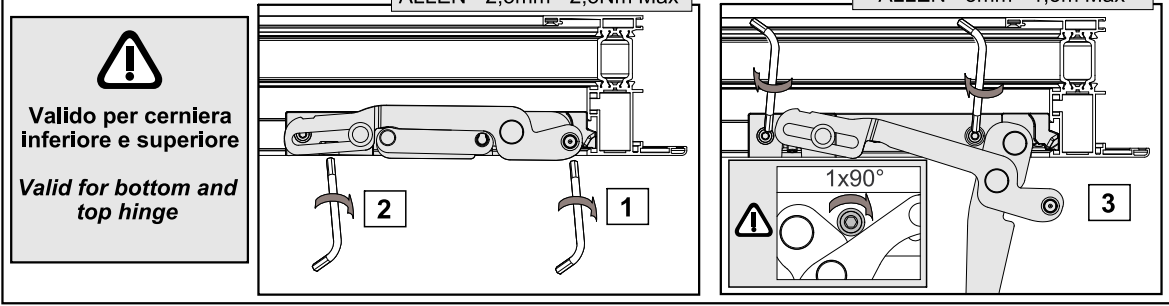

MONTAGGIO CERNIERA ANTA
HINGE SASH ASSEMBLY

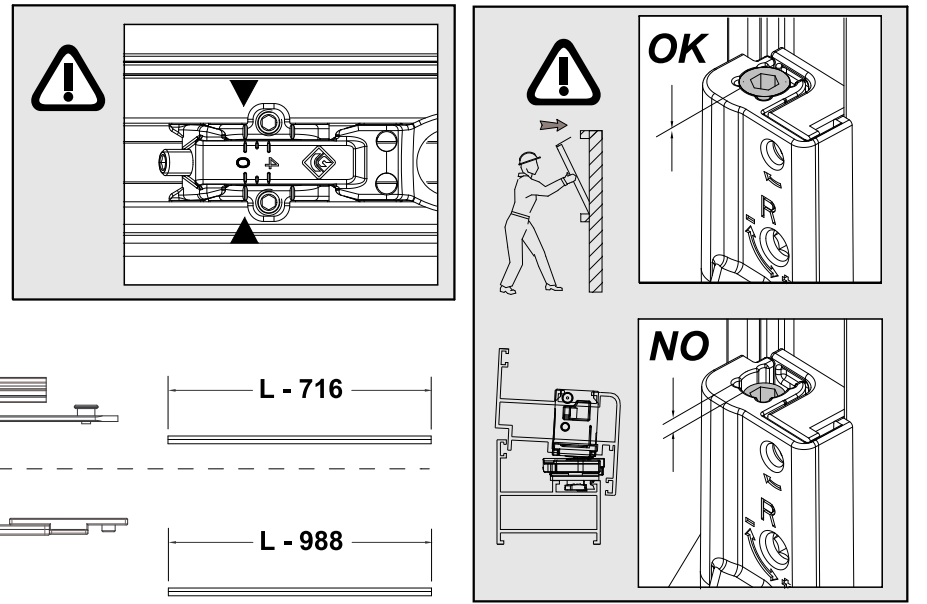

MANOVRA LOGICA TILT BEFORE TURN	
COD.	NODO
3550L.30	A01 - A05
3400LG.30	A03
ANTA RIBALTA TILT AND TURN	
COD.	NODO
3520.30	A01 - A05
3400G.30	A03

$1200\text{ mm} < L \leq 1700\text{ mm}$

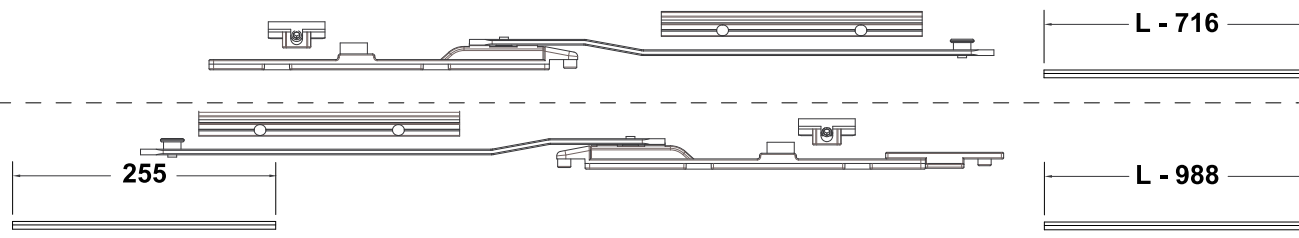

MANOVRA LOGICA TILT BEFORE TURN	
COD.	NODO
3304L.21S/D	A01 - A05
3303L.21S/D	A03
ANTA RIBALTA TILT AND TURN	
COD.	NODO
3304.21S/D	A01 - A05
3303.21S/D	A03

$670\text{ mm} < L \leq 1700\text{ mm}$

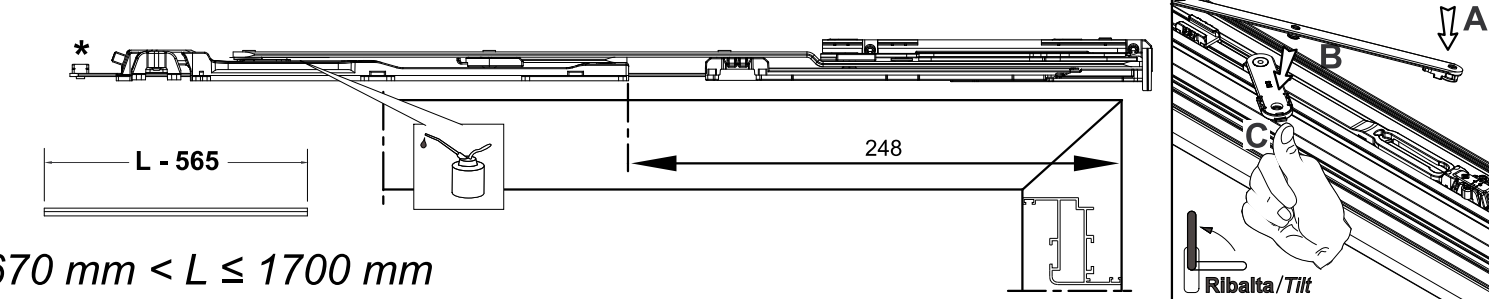

MANOVRA LOGICA TILT BEFORE TURN	
COD.	NODO
3304L.20S/D	A01 - A05
3303L.20S/D	A03
ANTA RIBALTA TILT AND TURN	
COD.	NODO
3304.20S/D	A01 - A05
3303.20S/D	A03

$470\text{ mm} < L \leq 670\text{ mm}$

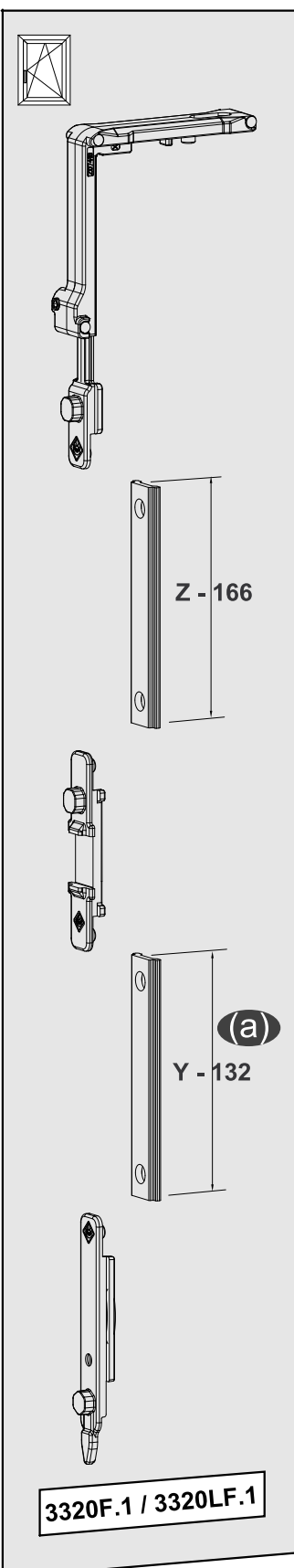
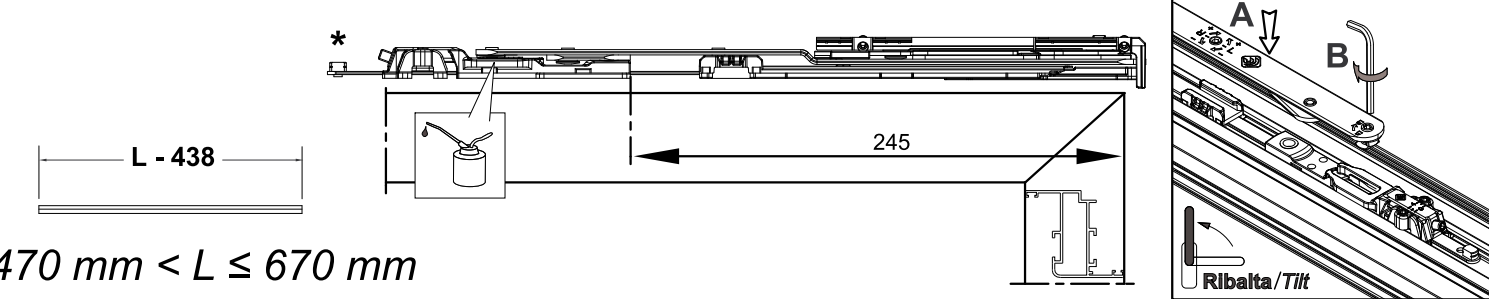

$H < 1400\text{ mm}$

COD.	DES.
330X.10S/D	Kit cerniere brac. corto Kit hinge short arm
330XL.10S/D	Kit cerniere brac. corto logica Kit hinge short arm logic
330X.11S/D	Kit cerniere brac. lungo Kit hinge long arm
330XL.11S/D	Kit cerniere brac. lungo logica Kit hinge long arm logic

Z - 246

Z - 249

3400F.32

3627 / 3627.2

3630 / 3630.20

(a) Y - 132

(b) Y - 163

(c) Y - 166

LOGICA
DOPPIA ANTA
DOUBLE SASH
TBT

(a)	Y - 140
(b)	Y - 171
(c)	Y - 174

330X S/D

L/2 - 132

3400.35

3400F.32

$L > 1200\text{ mm}$

$H > 1400\text{ mm}$

3420F.31

$H/2 - 166$

$H/2 - 400$

$H > 2200\text{ mm}$

Da abbinare a 3520.39
* In combination with 3520.39

**REGOLAZIONE
ADJUSTMENT**

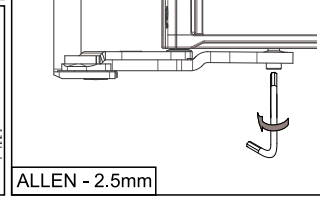
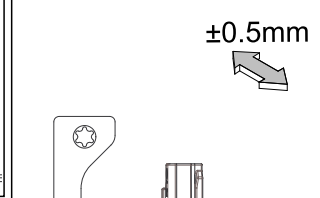
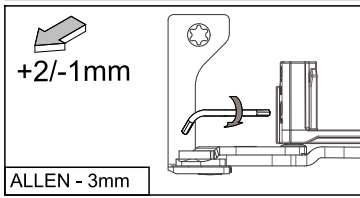
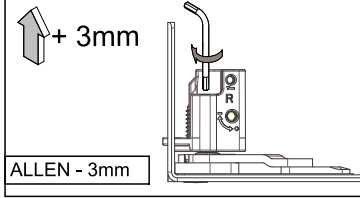
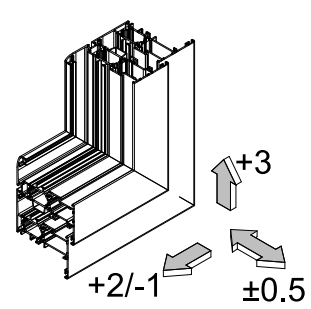
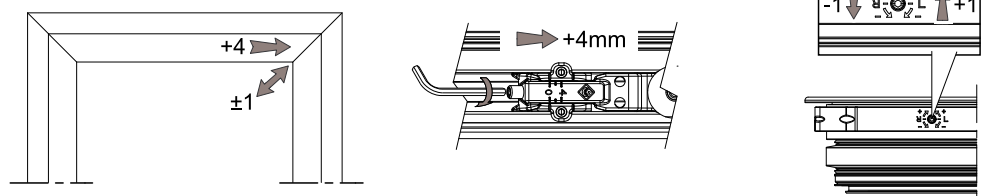

120Kg - 110°

2700	44	36	30	25	22	20	18	16	15	14	13	12	11	10
2600	46	37	31	26	23	21	18	17	15	14	13	12	11	10
2500	48	38	32	27	24	21	19	17	16	15	14	13	12	11
2400	50	40	33	29	25	22	20	18	17	15	14	13	12	11
2300	50	42	35	30	26	23	21	19	17	16	15	14	13	12
2200	50	44	36	31	27	24	22	20	18	17	16	15	14	13
2100	50	46	38	33	29	25	23	21	19	18	16	15	14	12
2000	50	48	40	34	30	27	24	22	20	18	17	16	15	13
1900	50	50	42	36	32	28	25	23	21	19	18	17	14	13
1800	50	50	44	38	33	30	27	24	22	21	19	16	15	14
1700	50	50	47	40	35	31	28	26	24	22	18	17	16	15
1600	50	50	50	43	38	33	30	27	25	21	19	18	17	13
1500	50	50	50	46	40	36	32	29	27	22	21	19	15	11
1400	50	50	50	49	43	38	34	31	26	24	22	17	13	9
1300	50	50	50	50	46	41	37	30	28	26	20	15	14	9
1200	50	50	50	50	50	44	36	33	30	18	17	16	10	5
1100	50	50	50	50	50	44	39	36	22	20	19	12	6	X
1000	50	50	50	50	50	48	43	26	24	22	14	7	X	X
900	50	50	50	50	50	50	32	29	18	8	X	X	X	X
800	50	50	50	50	50	40	36	22	11	X	X	X	X	X
700	50	50	50	50	50	46	14	X	X	X	X	X	X	X
600	50	50	50	50	40	19	X	X	X	X	X	X	X	X
550	50	50	50	50	X	X	X	X	X	X	X	X	X	X

150Kg - 90°

2700	50	44	37	32	28	25	22	20	19	17	16	15	14	13
2600	50	46	38	33	29	26	23	21	19	18	16	15	14	14
2500	50	48	40	34	30	27	24	22	20	18	17	16	15	14
2400	50	50	42	36	31	28	25	23	21	19	18	17	16	15
2300	50	50	43	37	33	29	26	24	22	20	19	17	16	15
2200	50	50	45	39	34	30	27	25	23	21	19	18	17	16
2100	50	50	48	41	36	32	29	26	24	22	20	19	18	15
2000	50	50	50	43	38	33	30	27	25	23	21	20	19	16
1900	50	50	50	45	39	35	32	29	26	24	23	21	18	17
1800	50	50	50	48	42	37	33	30	28	26	24	20	19	18
1700	50	50	50	50	44	39	35	32	29	27	23	21	20	19
1600	50	50	50	50	47	42	38	34	31	26	24	23	21	17
1500	50	50	50	50	50	44	40	36	33	28	26	24	19	14
1400	50	50	50	50	50	48	43	39	32	30	28	21	16	15
1300	50	50	50	50	50	46	38	35	32	25	18	17	11	6
1200	50	50	50	50	50	50	45	41	38	23	21	20	13	6
1100	50	50	50	50	50	50	49	45	27	25	23	15	6	X
1000	50	50	50	50	50	50	33	30	28	17	7	X	X	X
900	50	50	50	50	50	50	36	22	10	X	X	X	X	X
800	50	50	50	50	50	50	45	27	11	X	X	X	X	X
700	50	50	50	50	50	50	17	X	X	X	X	X	X	X
600	50	50	50	50	50	19	X	X	X	X	X	X	X	X
550	50	50	50	50	X	X	X	X	X	X	X	X	X	X

H min.	Braccio/Arm	Braccio/Arm
650mm	3312.20S/D	3311.20S/D
1050mm	3312.21S/D	3311.21S/D

Indicazioni di taglio Anta
Sash machining indication H - 1mm

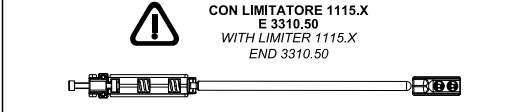

Kit anta ribalta a scomparsa | Per sistemi Camera Europea
Hidden kit for tilt and turn | For Euro Groove system

ITA

ENG

Riferimento nodo Camera Europea
Euro groove section riferiment

3311xx	A	B
3312xx	10	14
	14	18

LAVORAZIONI / MACHINING

**LAVORAZIONI ASTINE
RODS MACHINING**

**Maniglie
Handles**

6018

6038
6038.20D/S

6015 - 6015.3
6011 - 6011.10

6036 - 6032.10 - 6036.3
6036.20D/S
6036.23D/S

6061

6063
6063.20

3072

3077.2
3077.25D/S

3070

3070.2
3075.25D/S

3100

3101
3101.25

MASTER S.r.l. - I617E - A3 FR - 22/07/2022

Posizionamento punti chiusura | Positioning locking points | Positionnement points de fermeture | Posicionamiento puntos de cierre

ANTA RIBALTA | **TILT AND TURN**

T&T

3320F.1

Ribalta
Tilt

Apertura
Open

Chiusura
Locking

MANOVRA LOGICA | **TILT BEFORE TURN**

TBT

3320LF.1

Apertura
Open

Ribalta
Tilt

Chiusura
Locking

**MONTAGGIO CERNIERA INFERIORE
BOTTOM HINGE ASSEMBLY**

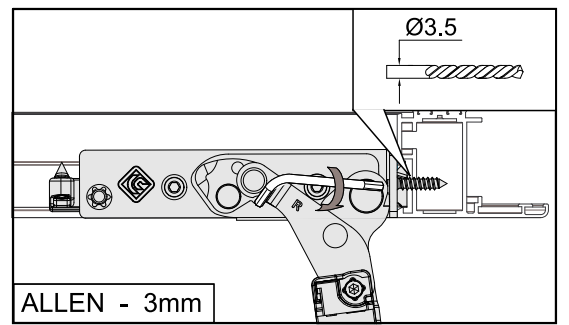
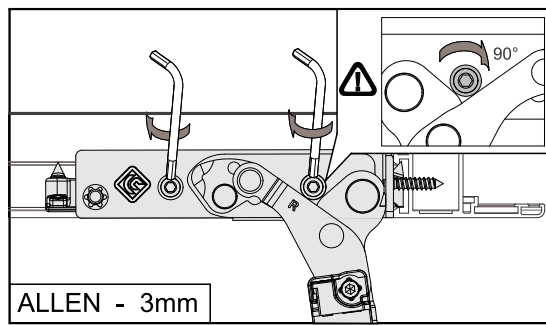
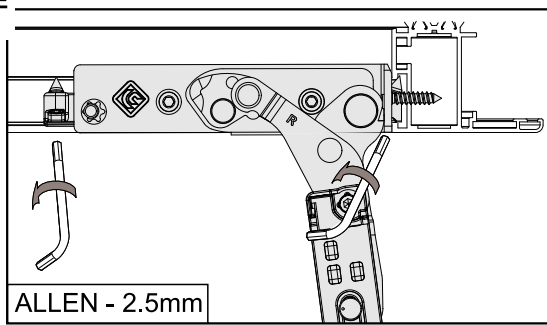
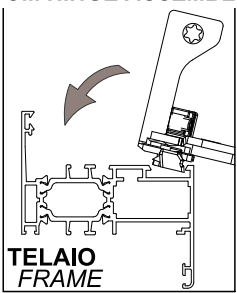

**MONTAGGIO CERNIERA SUPERIORE
TOP HINGE ASSEMBLY**

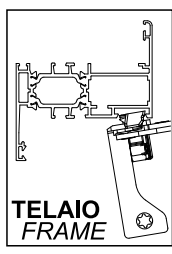
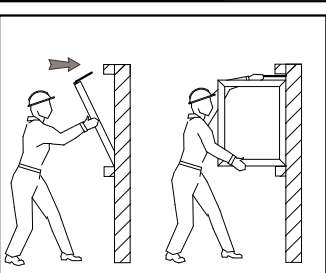
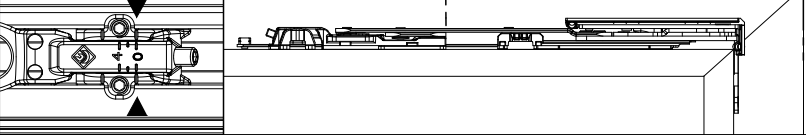
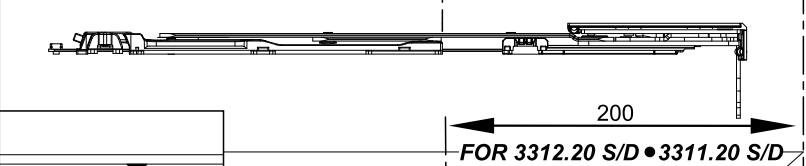
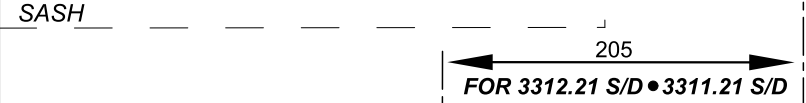
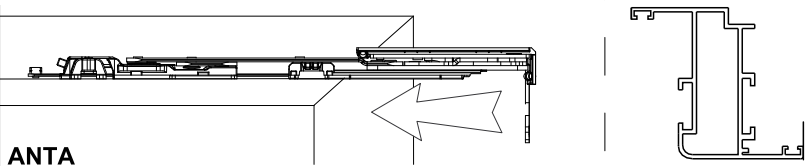

⚠
Per fissare la cerniera superiore sul telaio, seguire le istruzioni per il fissaggio della cerniera inferiore
To fix the top hinge on the frame, follow the instructions for the fixing of the bottom hinge

*** Da abbinare a microventilazione**
In combination with microventilation

3400.39 3311xx
3520.39 3312xx

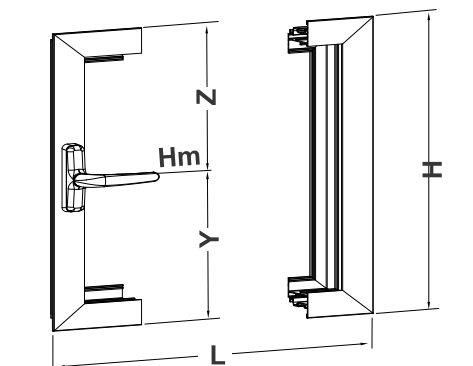
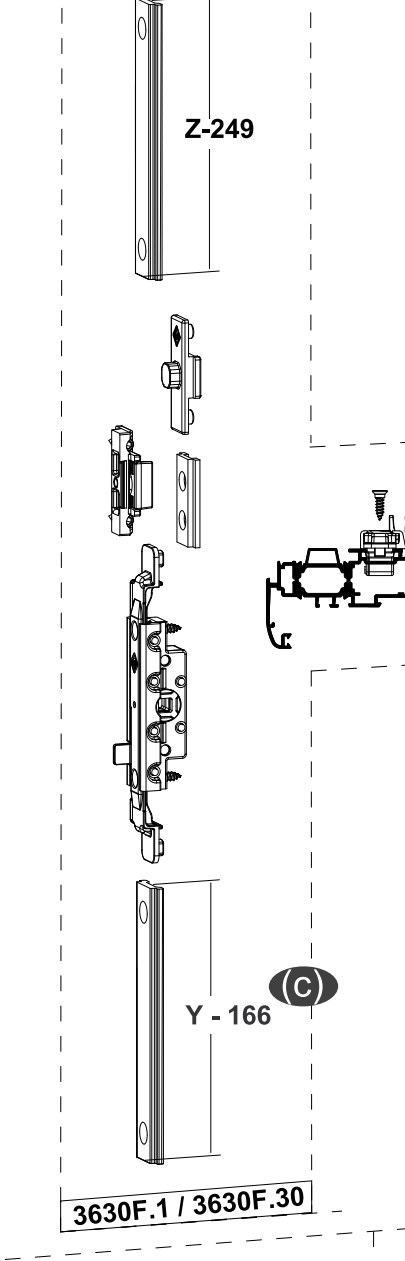
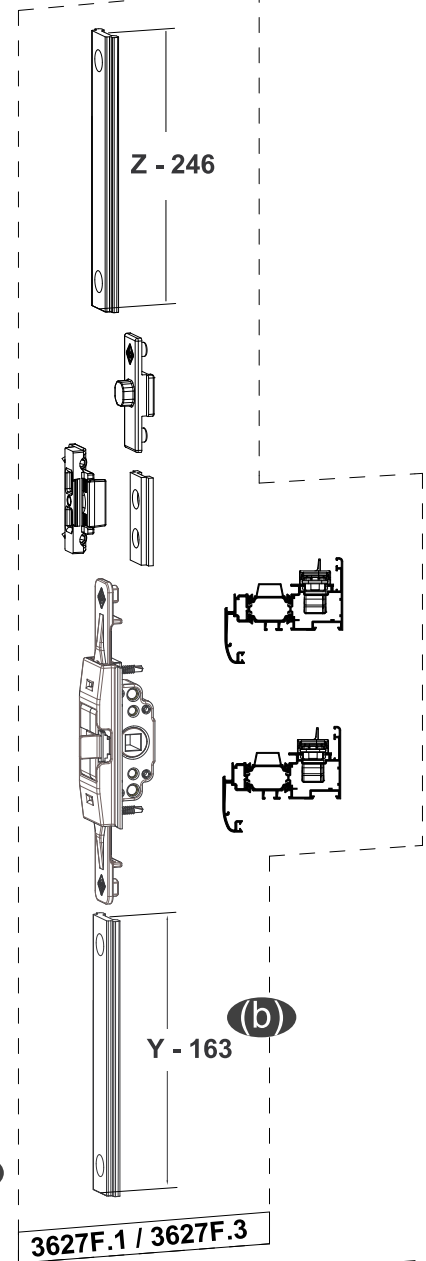
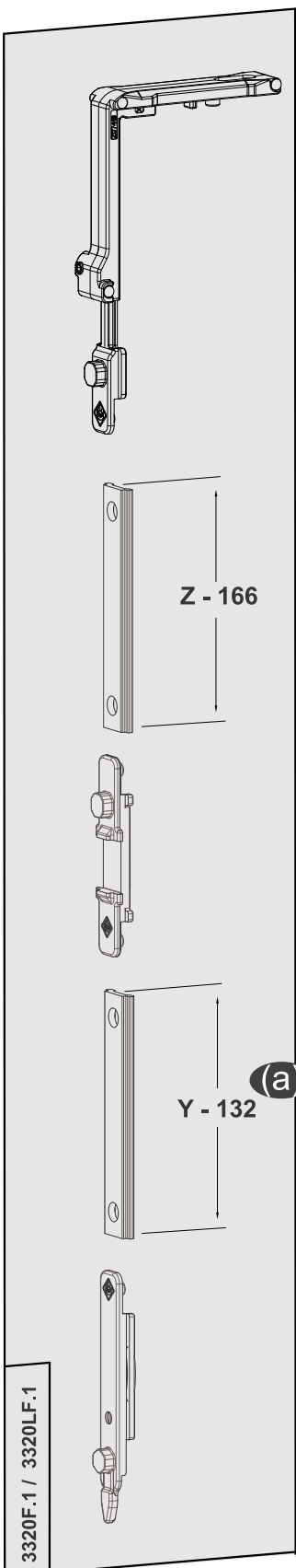
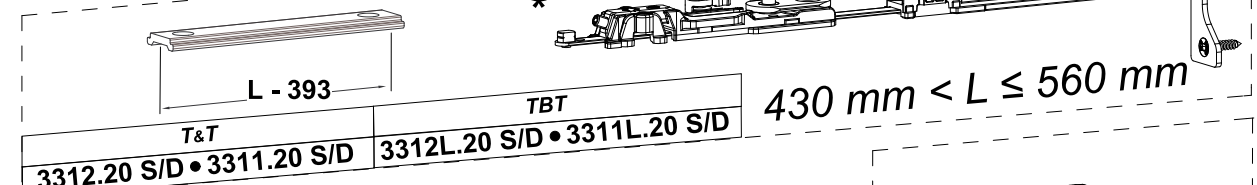
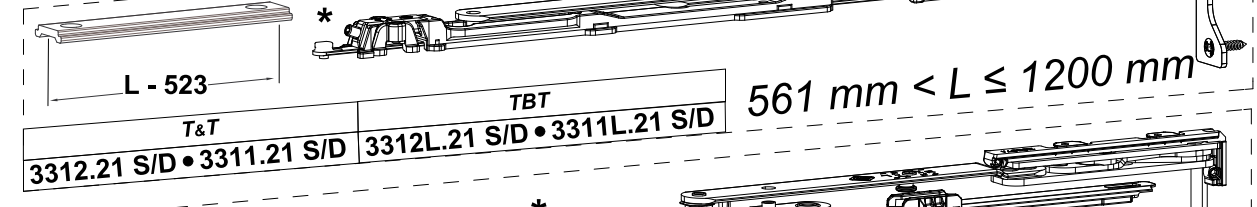
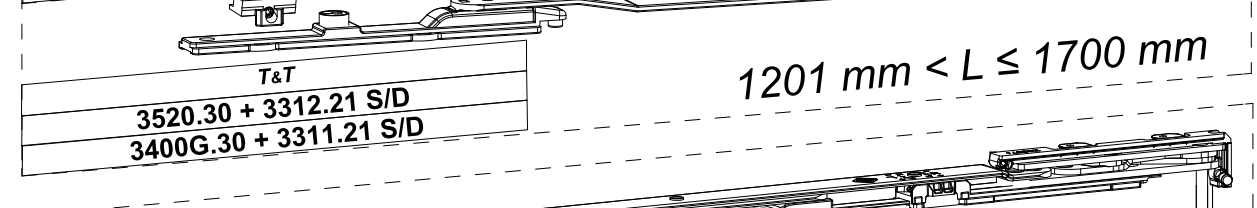
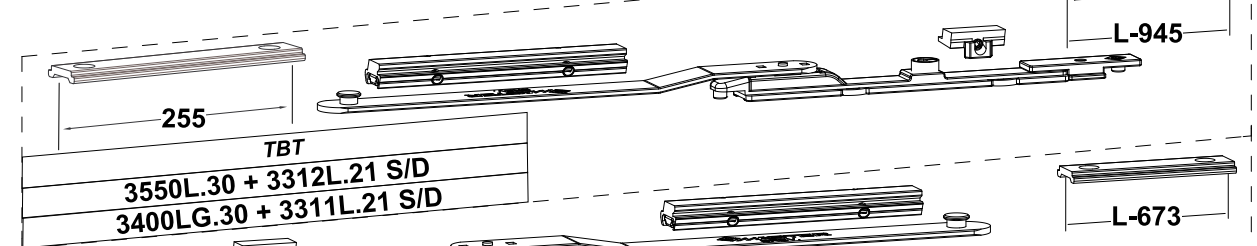

LOGICA DOPPIA ANTA DOUBLE SASH TBT	
(a)	Y - 140
(b)	Y - 171
(c)	Y - 174

